

ELMECA

TOOLING MANUAL

for

CNC Maching Center



PHONE :- 0836-440177-440178-440179

E-Mail :- elmece@dgf.vsnl.net.in

FAX :- 0836-742608 & 743808

ELMECA WORKS (Prop. : Pelma Engineering Industries Pvt. Ltd.)

BEHIND RAILWAY STATION, DHARWAD - 580007.

☎ : 0836-40177 / 8 / 9 FAX : 0836-391257



ELMECA CNC & N/C TOOLING SYSTEM

SLA-WE
SIDE LOCK HOLDER for end mill



P 15-16



P 4

FMB
FACE MILL ARBOR



P 5

FMC
SHOULDER CUTTER ARBOR



P 6

SMS
SHELL END MILL ARBOR



P 7

SCA
STUB ARBOR



P 8

P 9

MTA - MTB
MORSE TAPER ADAPTOR



JTA - B
Adaptor for Drill Chuck



DRAW BAR Type



P 10 11

DW
DOUBLE ANGLE COLLET
CHUCK



P 14



SLB
SIDE LOCK HOLDER for drill



P 12



MORSE TAPER
Socket

P 13



DRILL CHUCK
ADAPTOR

BSA
BORING BAR for square
Shank Boring Tool.



P 18 Angular Mounting

BSB
BORING BAR for square
Shank Boring Tool



P 19 Straight Mounting

ELMECA SHANK STYLE

BT 35

MATSUURA
ROKU ROKU
KITAMURA

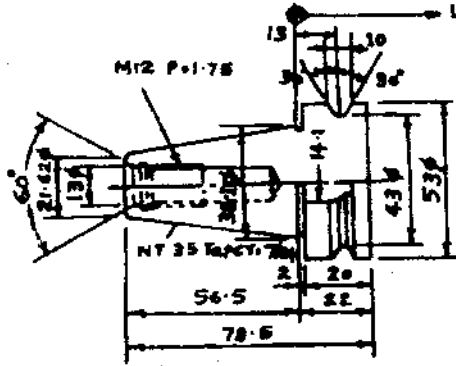

CAT 30

CATERPILLER

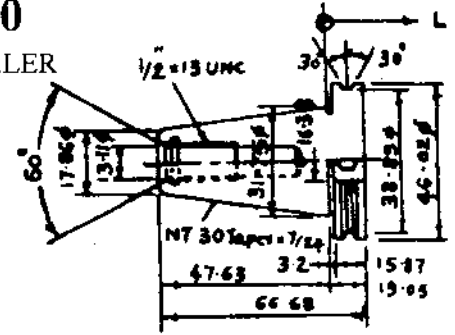

BT 40

MATSUURA, MAKINO MAZAK,
MITSUISEIKI, NIIGATA,
HITACHISEIKI, OKUMA
& HOWA, INKEGAL,
KURAKI, OKK
ROKU, ROKU,
TOSHIBA,
TOYODA,
TOYAMA.
URAWA, YASDA,
HITACHISEIKO,
TOYO ENSYU,
SIZUOKA, HAMAI,
HOWA KOGYO,

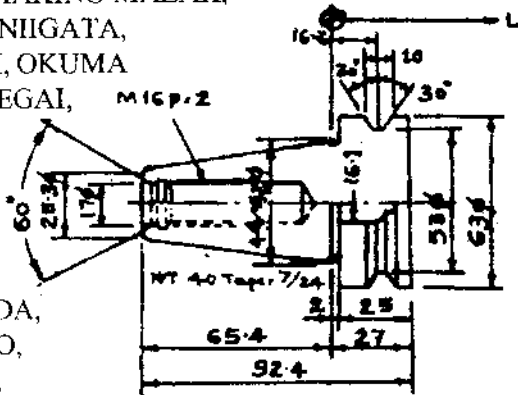

CAT 40

CATERPILLER

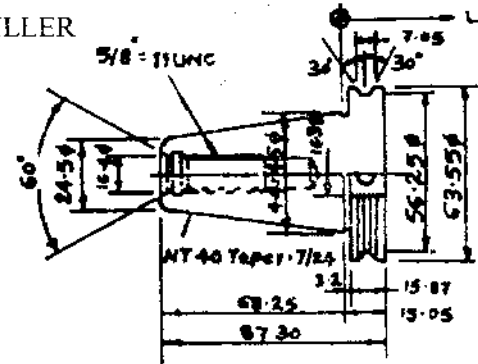

BT 45

MATSUURA HAMAI,
OKK, OOYA,
SIZUOKA,

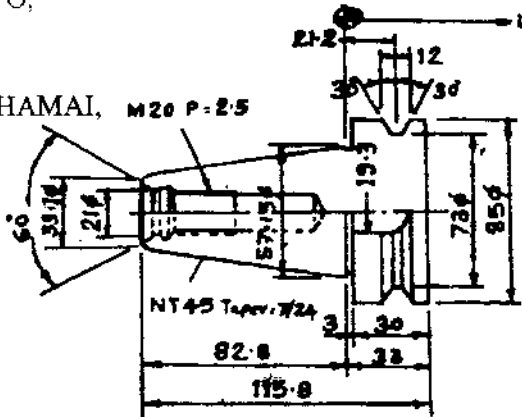

CAT 45

CATERPILLER

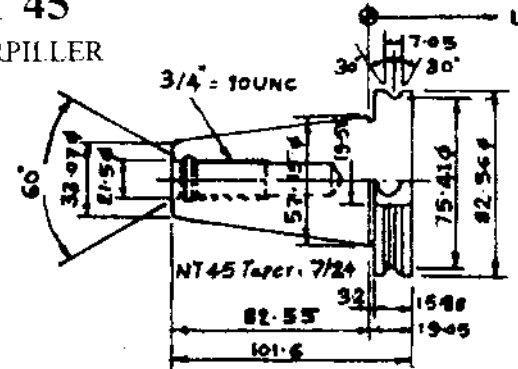

BT 50

MAKINO MAZAK MITSUBISHI,
MITSUISEIKI, NIIGATA,
HITACHISEIKI, HITACHI SIKO,
OKUMA,
& HOWA, HAMAI,
IKEGAL,
KURAKI,
OKK,
OKUMA,
OOYA SHIN
NIPPON,
TOSHIBA
TOYODA, YASDA,
KOTOBUKI,
NAKAMURA TOME,
TOYO,

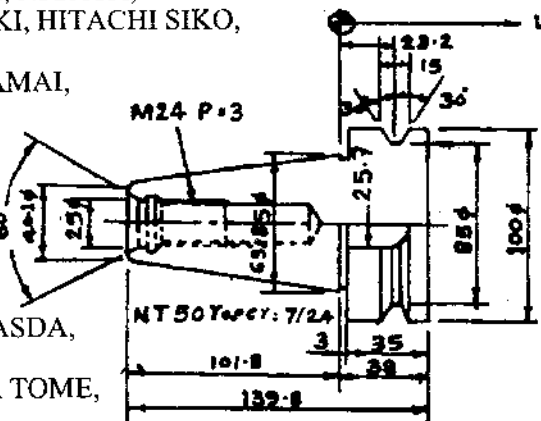

CAT 50

CATERPILLER

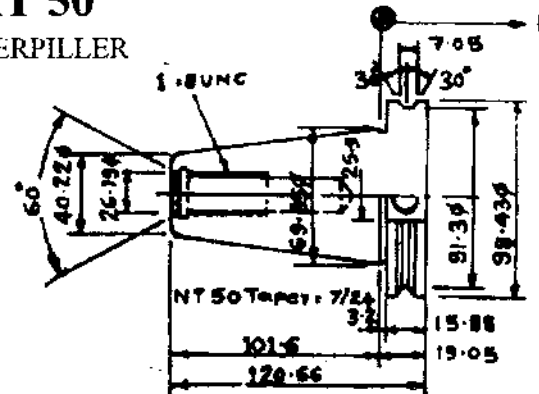

MACHINE MAKER	MACHINE M/C Model	Spindle taper	HOLDER shank style	PULL STUD ORDER BY No.			
				Standard	for MTB 2	for MTB 3	for MTB 4
MATSUURA	MC 500v (S)	NO 35	BT 35	PS U2			
	MC 710 v	40	40	-2			PS -10
MATSUURA MACHINERY	MC 1000v, 1500v MC 1500H	45	45	-4			PS-44
MAKINO MAKINO milling machine co.		NO 40	BT 40	PS-1			
	VNC, FNC, HNC series Mc 60,100	50	50	-5			
MAKINO SEIKI	MHNC 44-A-16	NO 30	CAT 30	PS-M7		PS-G6	
MAZAK YAMAZAKI machinery works.	V, V 5 V 75 H 10	NO 40	BT 40	PS-G5			PS-G7
	V 12,15 H 15, 20	50	50	-0 -G4			
MITSUBISHI MISUBISHI Heavy IND	MVA series MPA series	NO 50	BT 50	PS F1			
MITSUI SEIKI MITSUI SEIKI KOGYO CO.	HR 3A	NO 40	BT 40	PS P5			
	HR, JIDIC series VP series	50	50	-P			
NIIGATA NIIGATA Machine Tool Works	EN 40	NO 40	BT 40	PS-2		PS-29	PS-10
	HN 50, 70, 100	50	50	-6			
HITACHI SEIKI HITACHI SEIKI CO	MN 300	NO 30	CAT 30	PS-HO			
	VA 35 MINIMATIC 500, 630	40	BT 40	-1		PS-H3	PS-H0
	VA 40,50	50	50	-5			
HITACHI SEIKO	MG 500V 630 MG 500, 630, 800	50	50	-H1			
	MACCMATIC 36V, 48V	NO 40	BT40	PS-2		PS-29	PS-10
OKUMA & HOWA OKUMA & HOWA Mach. Ltd.	MBN 700	50	50	-C			
	MILLAC - 4H MILLAC -2 MILLAC 5VA	NO 40	BT 40	PS-1			
HAMAI HAMAI SANGYO LTD.	MC-5V	NO 45	BT 45	PS-3			
	MC 50V, 70V, 80V, 6V	50	50	-5			
IKEGAI IKEGAI MACHINERY CO.	MX 3	NO 40	BT40	PS-1			
	AMC 100	50	50	-5			
KURAKI KURASHIKI MACHINERY CO	KV 700 MH-400	NO 40	BT40	PS-1		PS-7	PS - 8
	KV - 1000	50	50	-5			
OKK OSAKA KIKO Co.	MCV - 350	NO 40	BT 40	PS-08			
	MCV 300 MCH - 450	45	45	-02			PS - 05
	MCV- 500 800 MCH 400,550,700	50	50	-0			
OKUMA OKUMA Machinery Co.	MC 5H	NO 50	BT 50	PS-6			
	MCR, MCM, MCV, MDBA	50	50	-B1			
OOYA OOYA Machinery works Co.	RE OM	NO 40	BT 40	PS-2			
	RE 1M	45	45	-4			
	RE 3M, 5M, 6m, ★ 2M	50	50	-P	★ PS-6		
RORU-ROKU ROKU-ROKU Sangyo I.TD.	MINIMAC VA	NO 35	BT 35	PS-R3			
	VO, V-1X, 1XW, MINIMAC - HIA	40	40	-1		PS 7	PS - 8
SHIN NIPPON SHIN NIPPON KOKI LTD.	HF, RB series	NO 50	NT 50	PS-S2			
	FSP 50V, 70V FSP 50H, 70H 130BH	50	50	-6			
TOSHIBA TOSHIBA KIKAI Co.	VMC 4	NO 40	BT 40	PS-1			
	BMC-5B, 6B, 8B BMC - 10B, 13B	50	50	-5			
TOYODA TOYODA Machinery works	FVN - 40	NO 40	BT40	PS-1			
	FVN-50, 50A FHN-50,60,80T	50	50	-5			
TOYAMA TOYAMA KIKAI	TMC 40V	NO. 40	BT 40	PS-1		PS-7	PS - 8
URAWA URAWA Machinery works Co.	UB-75	NO 40	BT 40	PS-1			
TOYO TOYO Kogyo Ltd	YPC - 30, 45	NO 40	BT40	PS-1		PS-7	PS - 8
	YBN-70N,90N	50	50	-5			
YASDA YASUDA IND. Co.	TMC-H40	NO 40	BT40	PS-1			
	TMC-H60	50	50	-5			
SIZUOKA SIZUOKA Iron works	B-3v	NO 40	BT40	--			
	B-10V	45	45	PS-A			
ENSYU	VMC-7040	NO 40	BT 40	PS-2			
KOTOBUKI	KMV-MC-450	NO 50	BT 50	PS-5			
HOWA KOGYO	MCV-80D	NO 40	BT 40	PS-1			
KITAMURA	MYCENTER - 2	NO 35	BT 35	PS-J			
NAKAMURA TOME	MU 5	NO 50	BT 50	PS-6			

When ordering tool holders with pullstuds separately. Please always specify " a) Model Number of machine. b) No of taper shank. as details of pullstuds may differ from MAS specification at each manufacturer. For details of ullstuds please turn to page.

ELMECA FACE MILL ARBOR

For Sandvik Coromant T-MAX face milling cutters

FMB

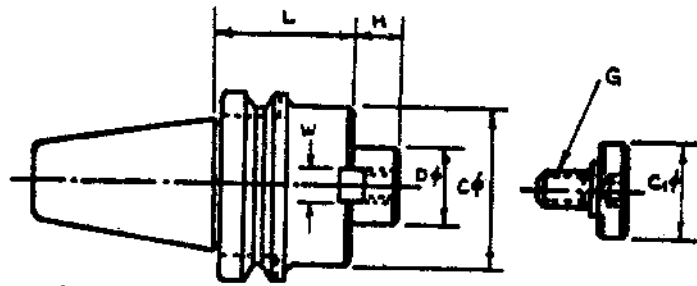

Fig-1

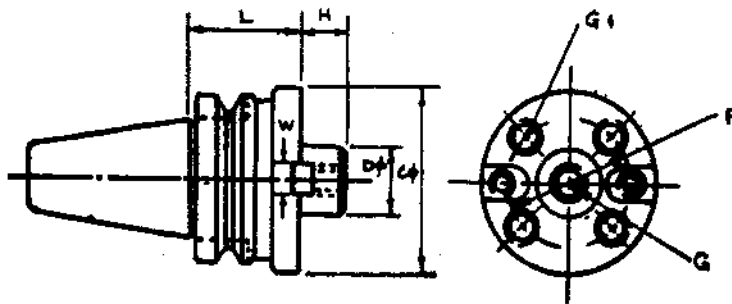

Fig-2

TAPER	ORDER BY NO.	D	L	H	C	C ₁	W	G	G ₁	P	Fig
No. 35	BT35-FMB27-40	27	40	26	80	33	12	M12	--	--	1
	-FMB40-40	40			85	50	16	M20			
No. 40	BT40-FMB27-60	27	60	26	80	33	12	M12	--	--	1
	-FMB27-90		90		85	50	16	M20			
	-FMB40-60	40	60		85	50	16	M20			
No. 45	BT45-FMB27-60	27	60	26	80	33	12	M12	--	--	1
	-FMB27-120		120		85	50	16	M20			
	-FMB40-60		60		85	50	16	M20			
	-FMB40-105		105		85	50	16	M20			
	-FMB40F-65	40	65		110			M12			66.7
No. 50	BT50-FMB27-45	27	45	26	80	33	12	M12	--	--	1
	-FMB27-90		90								
	-FMB27-150		150								
	-FMB40-45	40	45		85	50	16	M20	--	--	1
	-FMB40-75		75								
	-FMB40-105		105								
	-FMB40F-75		75								
	-FMB60-75	60	75		25	140	--	25.4	--	M16	101.6

Each holder is supplied with two driving dogs, a clamp bolt, and a hex wrench.

ELMECA SHOULDER CUTTER ARBOR

For Sandvik T-MAX Shoulder face milling Cutters

FMC

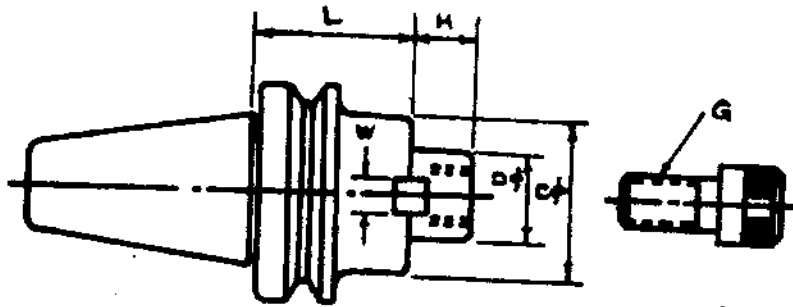

Fig. 1

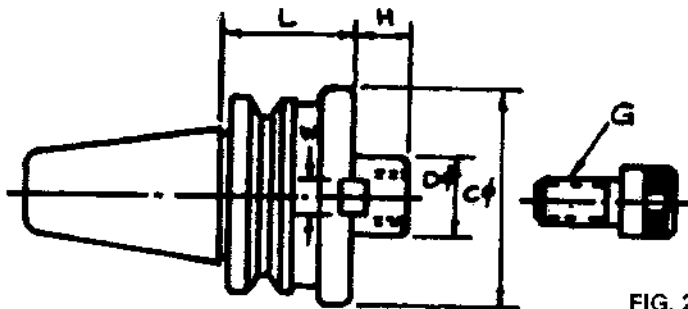

FIG. 2

TAPER	ORDER BY NO.	D	L	H	C	W	G CAP BOLT	Fig
No. 35	BT 35-FMC22-30	22	30	18	45	10	M10 X 30	1
	-FMC27-35	27	35	20	70	12	M12 X 35	2
	-FMC32-40	32	40	22	85	14	M16 X 35	
No. 40	BT 40-FMC22-45	22	45	18	45	10	M10 X 30	1
	-FMC22-90		90					2
	-FMC27-60	27	60	20	70	12	M12 X 35	
	-FMC27-90		90					
	-FMC32-60	32	60	22	85	14	M16 X 35	
	-FMC32-75		75					
No. 45	BT 45-FMC22-45	22	45	18	45	10	M10 X 30	1
	-FMC22-120		120					
	-FMC27-60	27	60	20	70	12	M12 X 35	
	-FMC27-120		120					
	-FMC32-60	32	60	22	85	14	M16 X 35	
-FMC32-105	105							
No. 50	BT 50-FMC22-60	22	60	18	45	10	M10 X 30	1
	-FMC22-105		105					
	-FMC22-150		150					
	-FMC27-45	27	45	20	70	12	M12 X 35	
	-FMC27-90		90					
	-FMC27-150		150					
	-FMC32-45	32	45	22	85	14	M16 X 35	
	-FCX32-75		75					
-FMC32-105	105							

Each holder is supplied with driving dogs, a clamp bolt, and a hex wrench.

ELMECA SHELL END MILL ARBOR

SMS

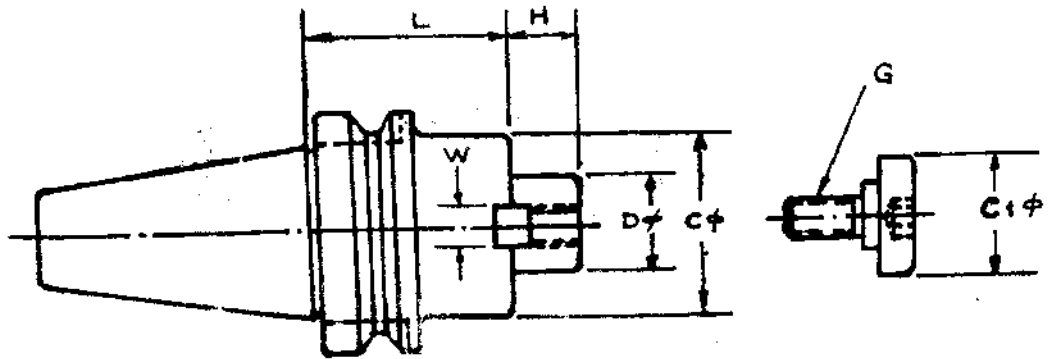

TAPER	ORDER BY NO.	D	L	H	C	C ₁	W	C ₁ φ
No. 35	BT35-SMS16-30	16	30	14	34	20	8	M8
	-SMS27-30	22		16	42	28		M10
	-SMS27-30	27	35	18	50	33	10	M12
	-SMS32-35	32		20	60	40		M16
No. 40	BT40-SMS16-60	16	60	14	34	20	8	M8
	-SMS16-120		120					
	-SMS22-60	22	60	16	42	28	10	M10
	-SMS22-120		120					
	-SMS27-45	27	45	18	50	33	12	M12
	-SMS27-105		105					
	-SMS32-45	32	45	20	60	40	14	M16
-SMS32-75	75							
No. 45	-BT45-SMS16-60	16	60	14	34	20	8	M8
	-SMS16-120		120					
	-SMS22-60	22	60	16	42	28	10	M10
	-SMS22-120		120					
	-SMS27-60	27	60	18	50	33	12	M12
	-SMS27-105		105					
	-SMS32-45	32	45	20	60	40	14	M16
-SMS32-75	75							
No. 50	BT50-SMS16-75	16	75	14	14	20	8	M8
	-SMS16-120		120					
	-SMS22-75	22	75	16	42	28	10	M10
	-SMS22-120		120					
	-SMS27-60	27	60	18	50	33	12	M12
	-SMS27-105		105					
	-SMS32-45	32	45	20	60	40	14	M16
	-SMS32-75		75					
	-SMS40-45	40	45	23	70	50	16	M20
	-SMS40-75		75					
-SMS50-60	50	60	26	90	65	18	M24	

Each holder is supplied with two driving dogs, a clamp bolt, and a hex wrench.

ELMECA STUB ARBOR

SCA

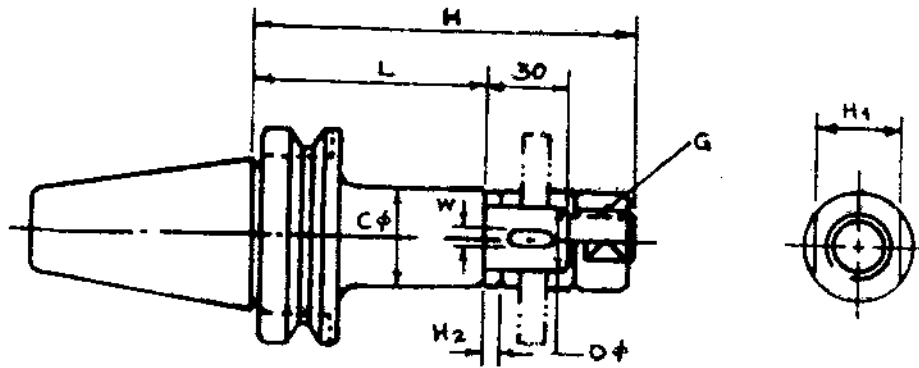

FAPIR	ORDER BY NO.	D	l	H	H ₁	C	W	G
No. 35	BT35-SCA13-75	13	75	120	17	20	—	M12
	-SCA16-75	16		121	23	26	4	M14
	-SCA22-75	22		126	29	34	6	M20
	-SCA27-75	27		130	32	40	7	M24
No. 40	BT40-SCA13-75	13	75	120	17	20	—	M12
	-SCA13-105		105	150				
	-SCA16-75	16	75	121	23	26	4	M14
	-SCA16-105		105	151				
	-SCA22-75	22	75	126	29	34	6	M20
	-SCA22-120		120	171				
	-SCA27-75	27	75	130	32	40	7	M24
	-SCA27-120		120	175				
-SCA32-90	32	90	150	41	46	8	M30	
No. 45	BT45-SCA13-75	13	75	120	17	20	—	M12
	-SCA13-105		105	150				
	-SCA16-90	16	90	136	23	26	4	M14
	-SCA16-120		120	166				
	-SCA22-90	22	90	141	29	34	6	M20
	-SCA22-135		135	186				
	-SCA27-90	27	90	145	32	40	7	M24
	-SCA27-135		135	190				
	-SCA32-90	32	90	150	41	46	8	M30
-SCA32-135	135		195					
No. 50	BT50-SCA13-75	13	75	120	17	20	—	M12
	-SCA13-105		105	150				
	-SCA16-90	16	90	136	23	26	4	M14
	-SCA16-120		120	166				
	-SCA22-90	22	90	144	29	34	6	M20
	-SCA22-135		135	186				
	-SCA27-90	27	90	145	32	40	7	M24
	-SCA27-135		135	190				
	-SCA32-90	32	90	150	41	46	8	M30
	-SCA32-135		135	195				
	-SCA40-90	40	90	156	46	55	10	M36
	-SCA40-135		135	201				

Each holder is supplied with a keepdistance key and set of distance collars.

(H₂ = 3, 5, 7, 8, 10, 12, mm).

ELMECA MORSE TAPER ADAPTER

MTA

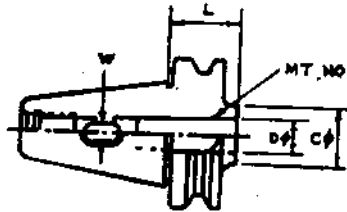

Fig. 1

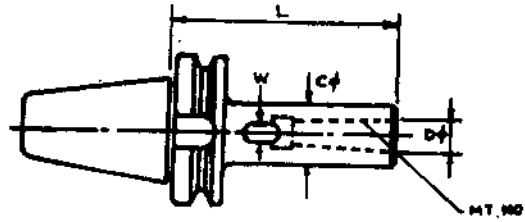

Fig. 2

TAPER	ORDER BY NO.	MT. NO.	D	L	C	W	Fig
No. 35	BT35-MTA1-45	1	12.065	45	25	5.6	1
	-MTA1-105			105			2
	-MTA2-60	2	17.780	60	32	6.6	1
	-MTA2-120			120			2
	-MTA3-75			3			23.825
No. 40	BT40-MTA1-45	1	12.065	45	25	5.6	1
	-MTA1-120			120			2
	-MTA2-60	2	17.780	60	32	6.6	1
	-MTA2-120			120			2
	-MTA3-75			3			23.825
	-MTA-3-135	135	2				
	-MTA4-95	4	31.267	95	50	12.4	1
-MTA4-165	165			2			
No. 45	BT45-MTA1-45	1	12.065	45	25	5.6	1
	-MTA1-120			120			2
	-MTA2-45	2	17.780	45	32	6.6	1
	-MTA2-135			135			2
	-MTA3-75	3	23.825	75	40	8.4	1
	-MTA3-150			150			2
	-MTA4-90	4	31.267	90	50	12.4	1
	-MTA4-180			180			2
-MTA5-120	5	44.399	120	70	16.5	2	
No. 50	-BT50-MTA1-45	1	12.065	45	25	5.6	1
	-MTA1-120			120			2
	-MTA1-180			80			1
	-MTA2-45	2	17.780	45	32	6.6	2
	-MTA2-135			135			1
	-MTA2-180			180			2
	-MTA3-45	3	23.825	45	40	8.4	1
	-MTA3-150			150			2
	-MTA3-180			180			
	-MTA4-75	4	31.267	75	50	12.4	1
	-MTA4-180			180			2
	-MTA5-105	5	44.399	105	70	16.5	1

ELMECA MORSE TAPER ADAPTER WITH DRAW BAR

MTB

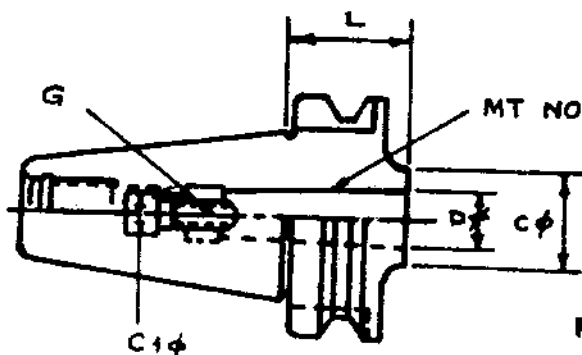

Fig-1 with draw bolt

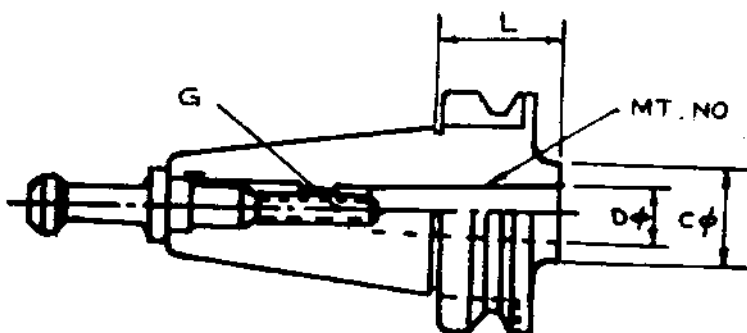

Fig-2 With pull-Studded draw bolt

TAPER	ORDER BY NO.	MT.NO.	D	L	C	C ₁	G	Fig
No. 35	BT35-MTB1-45	1	12.065	45	25	10	M 6 x 1	1
	-MTB2-30	2	17.780	30	32	-	M10 x 1.5	2
	-MTB3-60	3	23.825	60	40		M12 x 1.75	
No. 40	BT40-MTB1-45	1	12.065	45	25	10	M 6 x 1	1
	-MTB2-60	2	17.780	60	32	13.5	M10 x 1.5	2
	-MTB3-45	3	23.825	45	40	-	M12 x 1.75	
	-MTB4-84	4	31.267	85	50		M16 x 2	
No. 45	BT45-MTB1-45	1	12.065	45	25	10	M 6 x 1	1
	-MTB2-45	2	17.780		32	16	M10 x 1.5	
	-MTB3-60	3	23.825	60	40	18	M12 x 1.75	2
	-MTB4-75	4	31.267	75	50	-	M16 x 2	
No. 50	BT50-MTB1-45	1	12.065	45	25	10	M 6 x 1	1
	-MTB2-45	2	17.780		32	16	M10 x 1.5	
	-MTB3-60	3	23.825	60	40	18	M12 X 1.75	
	-MTB4-75	4	31.267	75	50	20.5	M16 X 2	

Morse Taper Adapters of type b as illustrated in fig 2 need special pullstuds.

When ordering these special pullstuds separately, please specify the pullstud code number

ELMECA ADAPTERS FOR DRILL CHUCK (DIN)

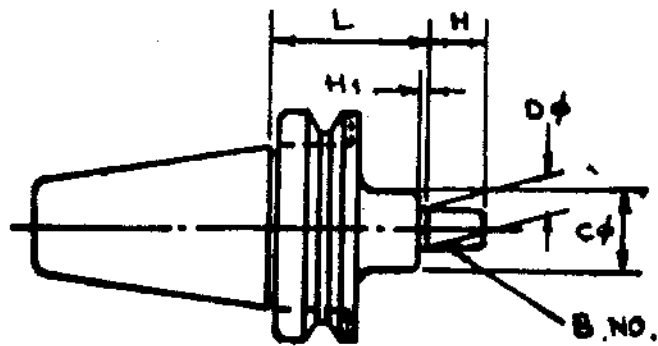

TAPER	ORDER BY NO.	B. No.	D	L	H	H ₁	C	
No. 35	BT35-B6-45	B 6	6.35	45	10	3	30	
	-B6-90			90				
	-B10-45	B 10	10.095	45	14.5			
	-B10-90			90				
	-B12-45	B 12	12.065	45	18.5			4
	-B12-90			90				
No. 40	BT40-B6-45	B 6	6.35	45	10	3	30	
	-B 6 - 90			90				
	-B10-45	B 10	10.095	45	14.5			
	-B10-90			90				
	-B 12- 45	B 12	12.065	45	18.5	4		
	-B12-90			90				
	-B16-45	B 16	15.733	45	24	5		
	-B16-90			90				
	-B18-45	B 18	17.431	45	25			
	-B18-90			90				
No. 45	BT45-B6-45	B 6	6.35	45	10	3	30	
	-B6-90			90				
	-B10-45	B 10	10.095	45	14.5			
	-B10-90			90				
	-B12-45	B 12	12.065	45	18.5	4		
	-B12-90			90				
	-B16-45	B 16	15.733	45	24	5		
	-B16-90			90				
	-B18-45	B 18	17.431	45	25			
	-B18-90			90				
No. 50	BT45-B6-45	B 6	6.35	45	10	3	30	
	-B6-90			90				
	-B10-45	B 10	10.095	45	14.5			
	-B10-105			105				
	-B12-45	B12	12.065	45	18.5	4		
	-B12-105			105				
	-B16-45	B 16	15.733	45	24	5		
	B-16-105			105				
	-B18-45	B 18	17.431	45	25			
	-B18-105			105				

Each drill chuck adapter is supplied without drill chuck.

ELMECA ADAPTERS FOR DRILL CHUCK (Jacobs)

JTA

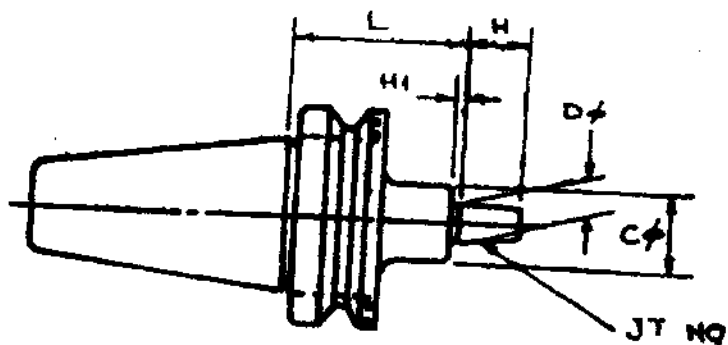

TAPER	ORDER BY NO.	JT. No.	D	L	H	H ₁	C
No. 35	-BT35-JTA1-30	1	9-754	30	15	3	30
	-JTA-2S-30	2 SHORT	13-94		18		
	-JTA-2-30	2	14-199		20		
	-JTA33-30	33	15-85		24	4	
	-JTA6-30	6	17-17		28		
	-JTA3-30	3	20-599		28		
No. 40	BT40-JTA1-45	1	9-754	45	15	3	30
	-JTA1-90			90			
	-JTA2S-45	2 SHORT	13-94	45	18		
	-JTA2S-90			90			
	-JTA2-45	2	14-199	45	20	4	
	-JTA2-90			90			
	-JTA33-45	33	15-85	45	24		
	-JTA33-90			90			
	-JTA6-45	6	17-17	45	24		
	-JTA6-90			90			
	-JTA3-45	3	20-599	45	28	5	
	-JTA3-90			90			
No. 45	BT45-JTA1-45	1	9-754	45	15	3	30
	-JTA1-90			90			
	-JTA2S-45	2 SHORT	13-94	45	18		
	-JTA2S-90			90			
	-JTA2-45	2	14-199	45	20	4	
	-JTA2-90			90			
	-JTA33-45	33	15-85	45	24		
	-JTA33-90			90			
	-JTA6-45	6	17-17	45	24		
	-JTA6-90			90			
	-JTA3-45	3	20-599	45	28	5	
	-JTA3-90			90			
No. 50	BT50-JTA1-45	1	9-754	45	15	3	30
	-JTA1-105			105			
	-JTA2S-45	2 SHORT	13-94	45	18		
	-JTA2S-105			105			
	-JTA2-45	2	14-199	45	20	4	
	-JTA2-105			105			
	-JTA33-45	33	15-85	45	24		
	-JTA33-105			105			
	-JTA6-45	6	17-17	45	24		
	-JTA6-105			105			
	-JTA3-45	3	20-599	45	28	5	
	-JTA3-105			105			

Each drill chuck adapter is supplied without drill chuck.

ELMECA SIDE LOCK HOLDER (for drill and ream)

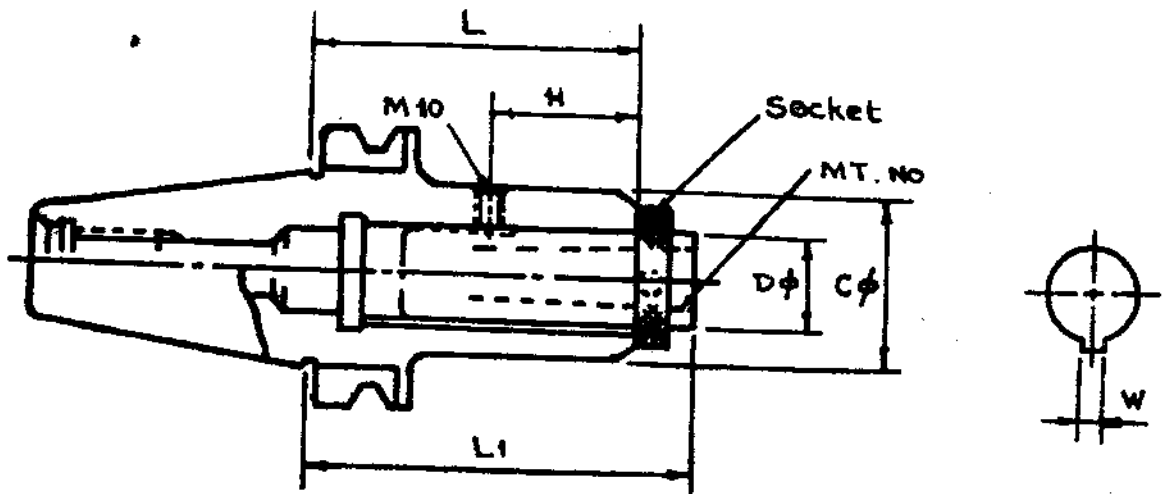

TAPER	ORDER BY NO.	D	L	L1	H	C	W	MT No.	Socket style
				Min~Max					
No. 35	BT35-SLB26-95	26	95	107~132	40	50	5	MT1	DSA26
								MT2	
No. 40	BT40-SLB26-105	26	105	117-142	40	50	5	MT1	DSA26
	-SLB35-135	35	135	147~182	55	60	6	MT2 MT3	
No. 45	BT45-SLB26-105	26	105	117-142	40	50	5	MT1	DSA26
	-SLB35-105	35		117~152	55	60	6	MT2 MT3	
No. 50	BT50-SLB26-105	26	105	117-142	40	50	5	MT1	DSA26
	-SLB35-120	35	120	132~167	55	60	6	MT2 MT3	
	-SLB48-165	48	165	181~227	65	80	8	MT3 MT4	DSA48

ELMECA Axially adjustable MORSE TAPER SOCKET for side lock holder

For use on SIDE LOCK HOLDER Type SLB

DSA-MT

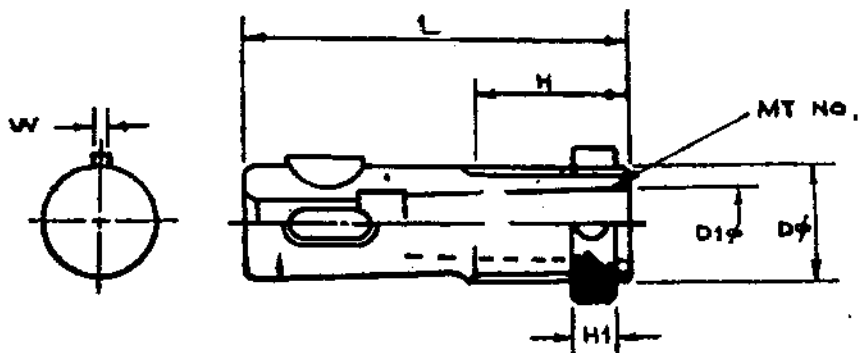

SLB No.	ORDER BY No.	D	D ₁	L	H	H ₁	W	MT No.
DSA26	DSA25-MT1	M26 P2	12.065	92	41	12	5	1
	-MT2		17.780					2
DSA35	DSA35-MT2	M35 P2	17.780	117	47	12	6	2
	-MT3		23.825					3
DSA48	DSA48-MT3	M48 P2	23.825	143	62	15	8	3
	-MT4		31.267					4

For DIN specifications, sockets with 28mm O.D. and 36mm O. D. are available. Ex. DSA 28-MT 2.

ELMECA Axially adjustable DRILL CHUCK ADAPTER for side lock holder

For use on SIDE LOCK HOLDER Type SLB

DSA-JT
-B

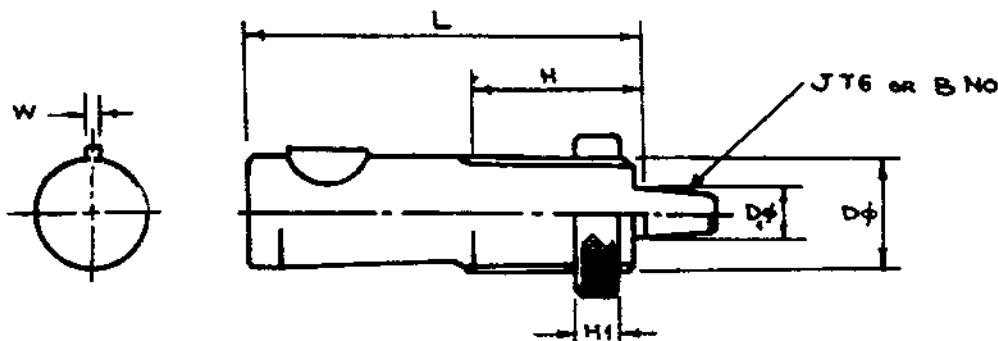

SLB No.	ORDER BY No.	D	D ₁	L	H	H ₁	W
DSA 26	DSA25-JT6	M26 P2	17.17	92	41	12	5
DSA 35	35-JT6	M35 P2		117	47		6
DSA 48	48-JT6	M48 P2		143	62		8
DSA 26	DSA26-B10	M26 P2	10.095	92	41	12	5
	-B12		12.065				
	-B16		15.733				
DSA 35	DSA35-B10	M35 P2	10.095	117	47	12	6
	-B12		12.065				
	-B16		15.733				
DSA 48	DSA48-B10	M48 P2	10.095	143	62	16	8
	-B12		12.065				
	-B16		15.733				

For DIN specifications, sockets with 28mm O.D. and 36mm O. D. are available. Ex. DSA 28-b 12.

ELMECA DOUBLE ANGLE COLLET CHUCK

(for Straight Shank Drill)

Each DW Collet Chuck is supplied without DK collet

DW

Please refer to the DK List below.

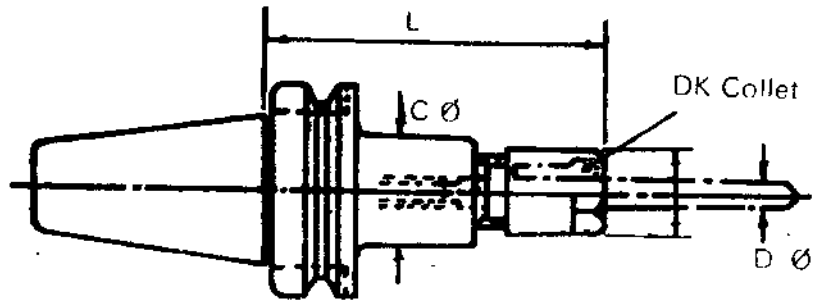

TAPER	ORDER BY NO.	D MIN ~ MAX	L	C	C ₁	Suitable DK collet
No. 35	BT 35 - DW 2-90	4.8 ~ 8.8	90	25	25	DK 2
	DW3-105	8.8 ~ 13.5	105	31	30	DK 3
No. 40	DW3-120	1.35 ~ 19.1	120	41	45	DK 4
	BT 40-DW3-105	8.8 ~ 13.5	105	35	31	DK 3
	DW4-120	13.5 ~ 19.1	120	45	41	DK 4
No. 45	DW5-135	19.1 ~ 25.4	135		53	DK 5
	BT 45 DW 3-105	8.8 ~ 13.5	105	35	31	DK 3
	DW4 - 120	13.5 ~ 19.1	120	45	41	DK 4
	DW5-135	19.1 ~ 25.4	135		53	DK 5

ELMECA DOUBLE ANGLE COLLETS

[for use on Double Angle Collet chuck]



DK 2	D	DK 3	D	DK 4	D	DK 2	D
ORDER BY NO.	Min ~ Max	ORDER BY NO.	Min ~ Max	ORDER BY NO.	Min ~ Max	ORDER BY NO.	Min ~ Max
DK 2-5.2	4.8 ~ 5.2	DK 3-9.6	8.8 ~ 9.6	DK 414.3	13.5 ~ 14.3	DK 1-59.8	19.1 ~ 19.8
-5.6	5.2 ~ 5.6	-10.4	9.6 ~ 10.4	-15.1	14.3 ~ 15.1	-20.6	19.8 ~ 20.6
-6.0	5.6 ~ 6.0	-11.2	10.4 ~ 11.2	-15.9	15.1 ~ 15.9	-21.4	20.6 ~ 21.4
-6.4	6.0 ~ 6.4	-12.0	11.2 ~ 12.0	-16.7	15.9 ~ 16.7	-22.2	21.4 ~ 22.2
-6.8	6.4 ~ 6.8	-12.8	12.0 ~ 12.8	-17.5	16.7 ~ 17.5	-23.0	22.2 ~ 23.0
-7.2	6.8 ~ 7.2	-13.5	12.8 ~ 13.5	-18.3	17.5 ~ 18.3	-23.8	23.0 ~ 23.8
-7.6	7.2 ~ 7.6			-19.1	18.3 ~ 19.1	-24.6	23.8 ~ 24.6
-8.0	7.6 ~ 8.0					-25.4	24.6 ~ 25.4
-8.4	8.0 ~ 8.4						
-8.8	8.4 ~ 8.8						

ELMECA SIDE LOCK HOLDER (for end mill) (Metric)

S L

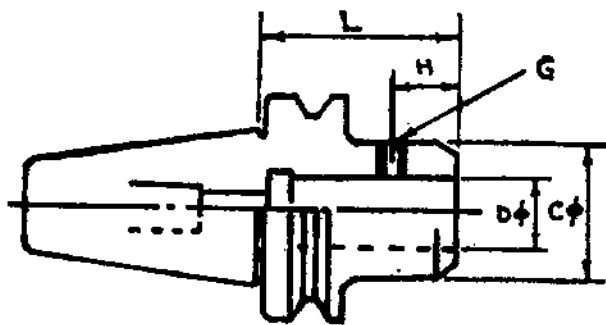

Fig.1

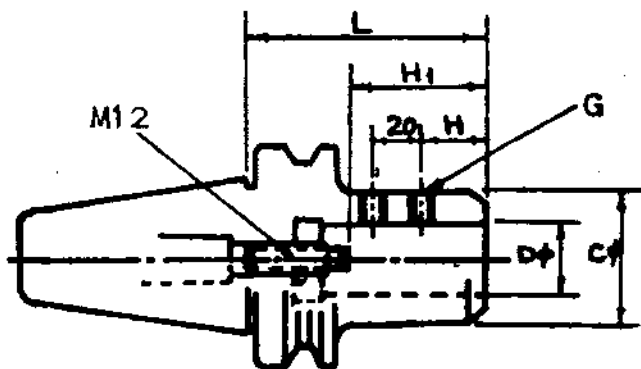

Fig.2

TAPER	ORDER BY No.	D	L	C	H	H ₁ Min ~ Max	G	Fig
No.35	BT35 -SL 6-60	6	60	20	15	—	M 6	1
	-SL 8-60	8		24	16		M 8	
	-SL 10-60	10		30	20		M 10	2
	-SL 12-60	12		35	22.5			
	-SL 16-60	16	40	25				
	-SLA 20-75	20	75	48	55 ~ 70	2		
	-SLA 25-90	25	90	60				
No. 40	BT40 -SL 6-65	6	65	20	15	—	M 6	1
	-SL 8-65	8		24	16		M 8	
	-SL 10-65	10		30	20		M 10	2
	-SL 12-65	12		35	23			
	-SL 16-65	16	40	25				
	-SLA 20-90	20	90	50	55 ~ 70	2		
	-SLA 25-90	25		60	30			
	-SLA 32-90	32		60	30			
No. 45	BT45 -SL 6-75	6	75	20	15	—	M 6	1
	-SL 8-75	8		24	16		M 8	
	-SL 10-75	10		30	20		M 10	2
	-SL 12-75	12		35	23			
	-SL 16-85	16	85	40	25			
	-SLA 20-90	20	90	50	55 ~ 70	2		
	-SLA 25-90	25		60	30			
	-SLA 32-90	32		60	30			
No. 50	BT50 -SL 6-75	6	75	20	15	—	M 6	1
	-SL 8-75	8		24	16		M 8	
	-SL 10-75	10		30	20		M 10	2
	-SL 12-75	12		35	23			
	-SL 16-75	16	40	25				
	-SLA 20-105	20	105	50	55 ~ 70	2		
	-SLA 25-105	25		60	30			
	-SLA 32-105	32		60	30			

Each holder is supplied with a hex wrench

ELMECA SIDE LOCK HOLDER (for end mill) (Inch)

W

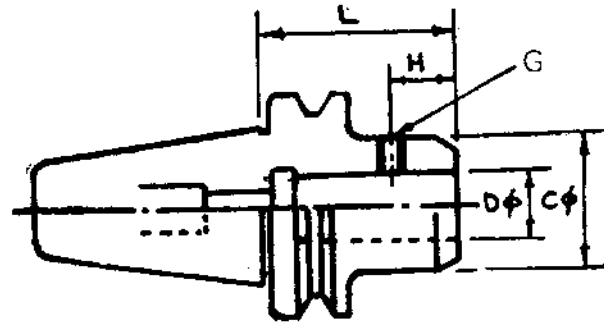

Fig. 1

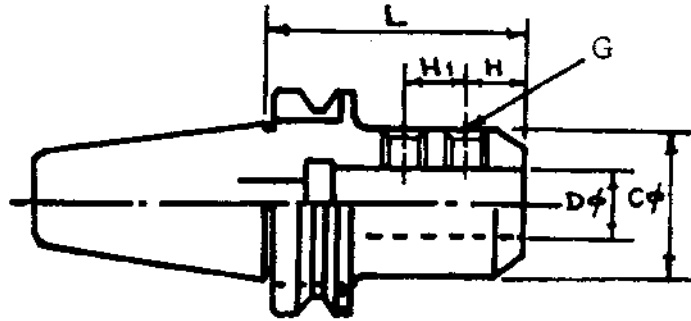

Fig. 2

TAPER	ORDER BY No.	D	L	C	H	H1	G	Fig		
NO. 35	BT35 -WE 1/4 - 60	6.35	160	20	15	-	1/4 -20	1		
	-WE 3/16 - 60	7.974		22			5/16 -18			
	-WE 1/8 - 60	9.525		25.5	3/8 -16					
	-WE 1/4 - 60	12.70		35	1/2 -14					
	-WE 3/8 - 60	15.875		42	5/8 -12					
	-WE 1/2 - 60	19.05		48	3/4 -11					
	-WE 3/8 - 70	22.225	70	58	16.5	20.6	5/8 -11		2	
	-WE 1 - 85	25.40	85	60	21	23	3/4 -10			
NO. 40	BT40 -WE 1/4 - 65	6.35	65	20	15	-	1/4 -20	1		
	-WE 3/16 - 65	7.937		22			5/16 -18			
	-WE 1/8 - 65	9.525		25.5	3/8 -16					
	-WE 1/4 - 65	12.70		35	1/2 -14					
	-WE 3/8 - 65	15.875		42	5/8 -12					
	-WE 1/2 - 65	19.05		48	3/4 -11					
	-WE 3/8 - 85	22.225	58	16.5	20.6	5/8 -11	2			
	-WE 1 - 85	25.40	85	60	21	23			3/4 -10	
NO. 45	BT45 -WE 1/4 - 75	6.35	75	20	15	-	1/4 -20	1		
	-WE 3/16 - 75	7.937		22			5/16 -18			
	-WE 1/8 - 75	9.525		25.5	3/8 -16					
	-WE 1/4 - 75	12.70		35	1/2 -14					
	-WE 3/8 - 85	15.875	85	42	22.5		5/8 -12		2	
	-WE 1/2 - 85	19.05	48	23	3/4 -11					
	-WE 3/8 - 90	22.225	58	16.5	23.6		5/8 -11			
	-WE 1 - 90	25.40	90	60	21		23			3/4 -10
	-WE 1 1/4 - 90	31.75	63	21	23		3/4 -10			
-WE 1 1/2 - 110	38.10	110	76	22.5	27	3/4 -10				
NO. 50	BT50 -WE 3/8 - 75	9.525	75	25.5	16	-	3/8 -16	1		
	-WE 1/2 - 75	12.70		35			1/2 -14			
	-WE 3/4 - 75	15.875		42	22.5		5/8 -12			
	-WE 1 - 75	19.05		48	23		3/4 -11			
	-WE 3/8 - 90	22.225	90	58	16.5		20.6		5/8 -11	2
	-WE 1 - 105	25.40	60	21	23		3/8 -11			
	-WE 1 1/4 - 105	31.75	105	63	21		23		3/8 -11	
	-WE 1 1/2 - 105	38.10	105	76	27		27		3/8 -10	

ELMECA Axially adjustable MORSE TAPER SOCKET for collet chuck

NK-MT

For use on-Roll-A-Lock collet Chucks C32

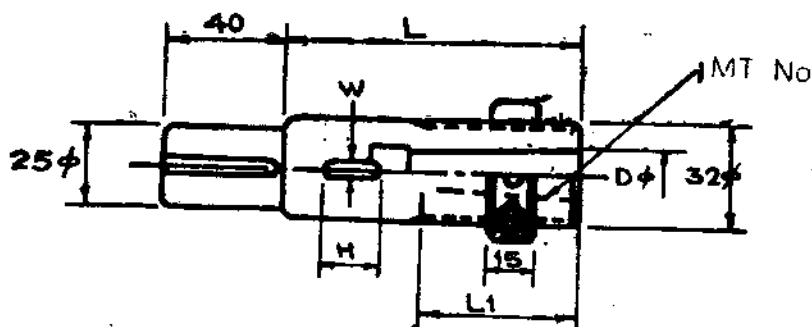

	ORDER BY NO.	MT No.	D	L	L	H	W
32	NK 32 - MT1	MT 1	12 065	82	42	19	5.2
	- MT2	MT 2	17 780			22	6.3
	- MT3	MT 3	23 825	87	47	27	7.9

ELMECA Axially adjustable DRILL CHUCK ADAPTER for collet chuck

For use on-Roll-A-Lock collet Chucks C32

ND

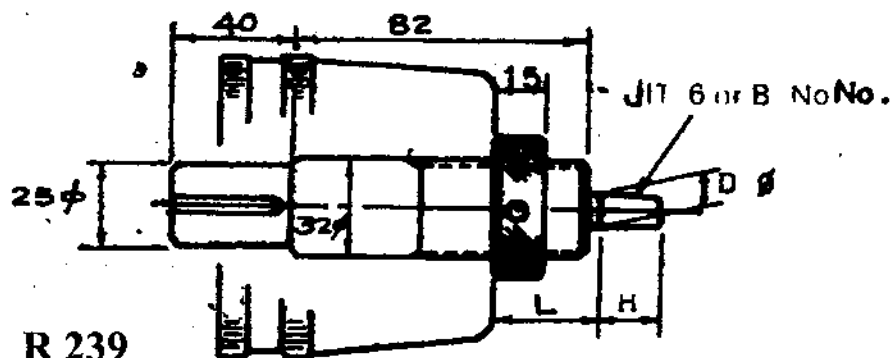

ISO R 239

	ORDER BY NO.	B. NO.	B. NO.	L	H
32	ND 32 - B 6	B 6	6.35	19	10
	- B 10	B 10	10.095		14.5
	- B 12	B 12	12.065		18.5
	- B 16	B 16	15.733	20	24
	- B 18	B 18	17.431		25

JACOBS TAPER

	ORDER BY NO.	JT. NO.	D	L	H
32	ND 32 - JT 1	1	9.754	19	15
	- JT 2S	2 SHORT	13.94		18
	- JT 2	2	14.199		20
	- JT 33	33	15.85	20	24
	- JT 6	6	17.17		28
	- JT 3	3	20.599		

Each drill chuck adapter is supplied without drill chuck.

ELMECA BORING BAR for Square Shank Boring Tool-Type A

BSA

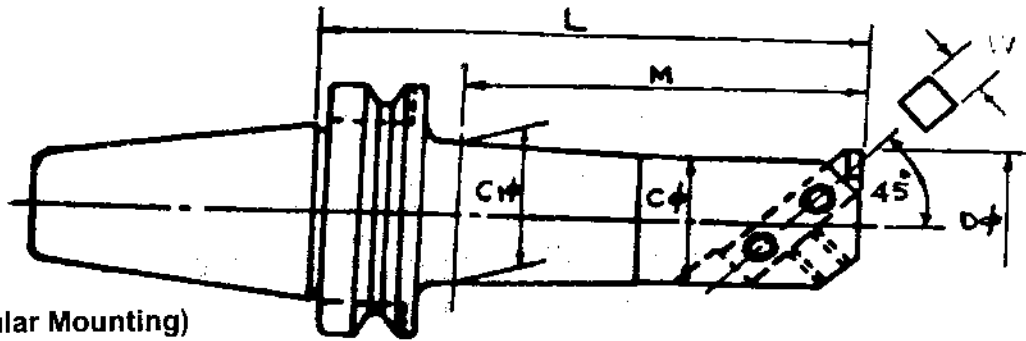

(Angular Mounting)

TAPER	ORDER BY No.	D	L	C	C ₁	W	L
		Min ~Max					
No. 35	BT35-BSA 25-120	25 ~ 38	120	20	22	8	90
	-BSA 30-135	30 ~ 42	135	24	26		105
	-BSA 38-150	38 ~ 52	150	30	33	10	100
	-BSA 42-150	42 ~ 56		34	37		125
	-BSA 50-150	50 ~ 65		40	44	13	
	-BSA 62-135	62 ~ 90	135	50	50	16	—
	-BSA 72-135	72 ~ 110		60	52	19	
No. 40	BT 40-BSA 25-165	25 ~ 38	135	20	22	8	108
	-BSA 30-165	30 ~ 42	165	24	26		138
	-BSA 38-180	38 ~ 52	180	30	33	10	153
	-BSA 42-210	42 ~ 56	210	34	37		183
	-BSA 50-180	50 ~ 65	180	40	44	13	153
	-BSA 50-225		225				198
	-BSA 62-180	62 ~ 90	180	50	56	16	153
	-BSA 62-240		240				213
	-BSA 72-180	72 ~ 110	180	60	63	19	153
	-BSA 72-240		240				213
	-BSA 90-180	90 ~ 125	180	75	—	—	
No. 45	BT45-BSA 25-135	25 ~ 38	135	20	22	8	95
	-BSA 30-165	30 ~ 42	165	24	26		125
	-BSA 38-180	38 ~ 52	180	30	33	10	140
	-BSA 42-210	42 ~ 56	210	34	37		170
	-BSA 50-180	50 ~ 65	180	40	44	13	140
	-BSA 50-225		225				185
	-BSA 62-195	62 ~ 90	195	50	56	16	155
	-BSA 62- 270		270				230
	-BSA 72-195	72 ~ 110	195	60	66	19	155
	-BSA 72-285		285				245
	-BSA 90-195	90 ~ 125	195	75	75	19	160
	-BSA 90-285		285		80		250
	No. 50	BT50-BSA 25-135	25 ~ 38	135	20	22	8
-BSA 50-165		30 ~ 42	165	24	26	125	
-BSA 38-180		38 ~ 52	180	30	33	10	140
-BSA 42-210		42 ~ 56	210	34	37		170
-BSA 50-180		50 ~ 65	180	40	44	13	140
-BSA 50-240			240				200
-BSA 62-195		62 ~ 90	195	50	56	16	155
-BSA 62-270			270				230
-BSA 72-195		72 ~ 110	195	60	66	19	155
-BSA 72-285			285				245
-BSA 90-210		90 ~ 125	210	75	80	19	170
-BSA 90-300			300				260

ELMECA BORING BAR for Square Shank Boring Tool-Type B

BSB

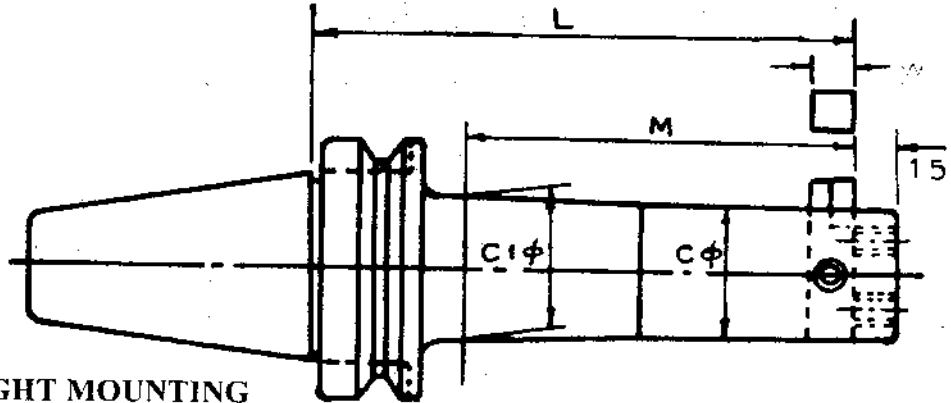

STRAIGHT MOUNTING

TAPER	ORDER BY No.	D		L	C	C ₁	W	M
		Min	Max					
No. 35	BT35-BSB 25-120	25	50	120	20	22	8	90
	-BSB 38-150	38	70	150	30	33	10	120
	-BSB 50-150	50	90		40	44	13	125
	-BSB 62-135	62	115	135	50	50	16	-
	-BSB 72-135	72	135		60	52	19	
No. 40	BT 40-BSB 25 -135	25	50	135	20	22	8	108
	-BSB 38-180	38	70	180	30	33	10	153
	-BSB 50-180	50	90	225	40	44	13	198
	-BSB 50 -225		40		44	13	198	
	-BSB 62-180	62	115	180	50	56	16	153
	-BSB 62-225		115	225	50	56	16	198
	-BSB 72-180	72	135	180	60	63	19	153
	-BSB 72-225		135	225				198
	-BSB 90-180	90	150	180	75	-	-	198
	-BSB 90-225		150	225				225
No. 45	BT45-BSB 25-135	25	50	135	20	22	8	95
	-BSB 38-180	38	70	180	30	32	10	140
	-BSB 50-180	50	90	225	40	44	13	185
	-BSB 50 225		40		44	13	185	
	-BSB 62-195	62	115	195	50	56	16	140
	-BSB 62-270		115	270	50	56	16	230
	-BSB72- 195	72	135	195	60	66	19	155
	-BSB72-285		135	285				245
	-BSB 90-195	90	150	195	75	75	89	160
	-BSB 90-285		150	285				250
	-BSB105-195	105	190	195	90	-	25	162
	-BSB105-285		190	285				252
No. 50	BT50-BSB 25-135	25	50	135	20	22	8	95
	-BSB 38-180	38	70	180	30	32	10	140
	-BSB 50-180	50	90	240	40	44	13	200
	-BSB 50- 240		40		44	13	200	
	-BSB 62-195	62	115	195	50	56	16	155
	-BSB 62-270		115	270	50	56	16	230
	-BSB72- 195	72	135	195	60	66	19	155
	-BSB 72-285		135	285				245
	-BSB 90-210	90	150	210	75	80	19	170
	-BSB 90-300		150	300				260
	-BSB105-195	105	190	195	90	-	25	155
	-BSB105-285		190	285				245

ELMECA PULL STUD

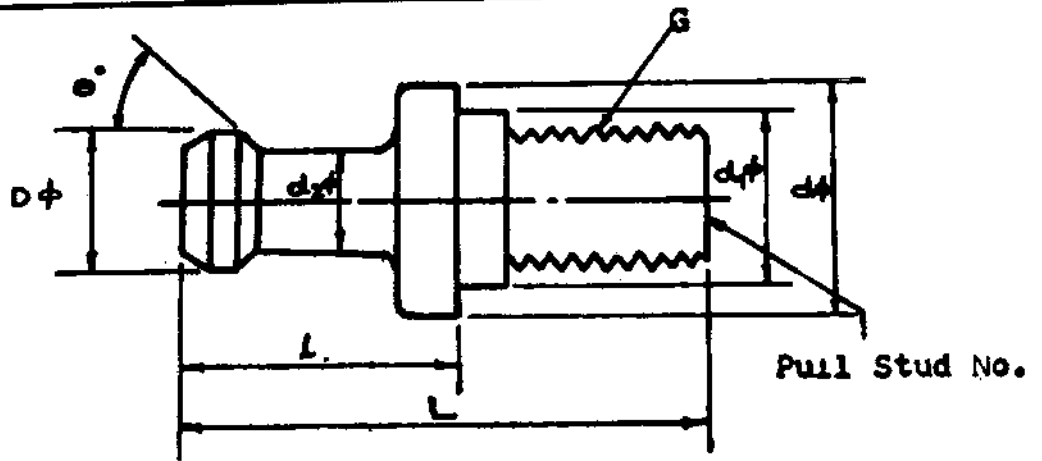

Pullstud No.	D	d	d ₁	d ₂	L	L	G	θ°	Type
PS-1	15	23	17	10	60	35	M16	45°	BT 40-I-standard
-2								60°	-II-standard
-3	19	31	21	14	70	40	M20	45°	BT45 - I-standard
-4								60°	BT-II-standard
-5	23	38	25	17	85	45	M24	45°	BT50-I-standard
-6								60°	-II-standard
-7	15	23	17	10	87	35	M12	45°	BT40-I-MTB3
-8					108		M16		-I-MTB4
-10					87		M12	60°	-II-MTB4
-29									
-31	19	31	21	14	125	40	M16	45°	BT45-I-MTB4
-44								60°	BT45-II-MTB4
-B	22	38	25	16	85	47	M24	60°	OKUMA
-B1					112				
-F	23	35	25	18	79	39	M24	4R	MITSUBISHI
-F1		39			104				
-G4	23	38	--	17	85	45	M24	90°	MAZAK-BT50
-G5	15	23	17	10	54.6	30	M16		-BT40
-G6					82		M12		-MTB3
-G7					103		M16		-MTB4
-H	22	38	27	17	86	48	U-1"	45°	HITACHI-BT50
-H7	15	23	17	10	60	35	M16		-BT40
-H8					87		M12		-MTB3
-H9					108		M16		-MTB4
-M	20	--	--	14	70	--	M24	45°	MAKINO-BSS50
-O	23	38	25	17	85	45	M24	90°	OKK-BT50
-O2	19	31	21	14	70	40	M20		-BT45
-O5					125		M16		-MTB4
-P	24	36	25	18	71	31	M24	90°	MITSUI SEIKI
-S	25	39	25	18	70	30	M24	60°	SHIN NIPPON
-S2					95				55
-T5	19	35	25	14	67	27	M24	45°	TOSHIBA - BSS50
-U2	13.7	20	13	8.9	53	28	M12	60°	MATSUURA BT35
-U3					71		M10		-MTB2
-U4					85		M12		-MTB3

ELMECA MACHINE TOOL ACCESSORIES

COLLETS

DIN6341

TYPE RD

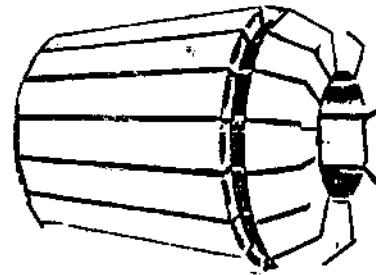
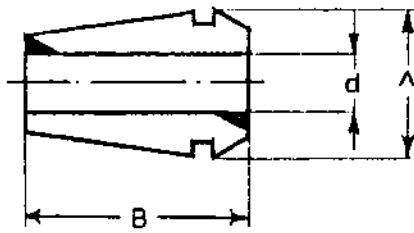

TYPE	A mm	SIZE RANGE	d mm	IN STEPS OF	Range Clamping	B mm
RD8	8.5	1.5		0.5	0.5.5	13.5
RD11	11.5	1.7		0.5	0.5.7	18
RD12	12.0	1.3		0.5	0.5.7	20
		4.7		1.0		
RD16	17.0	1.10		1.0	0.5.10	27
RD20	21.0	2.13		1.0	1.0.13	31
RD25	26.0	2.16		1.0	1.0.16	35
RD32	33.0	3.20		1.0	2.0.20	40
RD40	41.0	4.26		1.0	3.0.26	46
RD 50	52.0	12.34		2.0	10.34	60

COLLETS

TYPE RDG

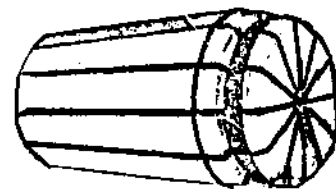
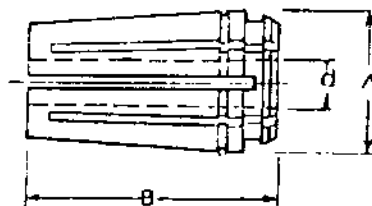

TYPE	d mm	A mm	B mm
RDG 100	6.25	35	60
RDG 150	12.40	51	76

AVAILABLE IN 0.25mm INCREMENTS, MAX COLLAPSE 0.4mm

ELMECA MACHINE TOOL ACCESSORIES

COLLETS

DIN 6388 FORM B

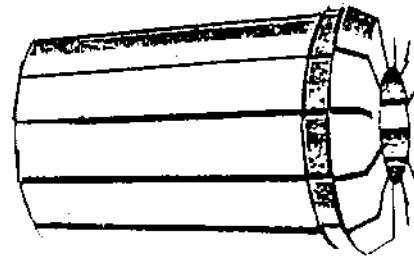
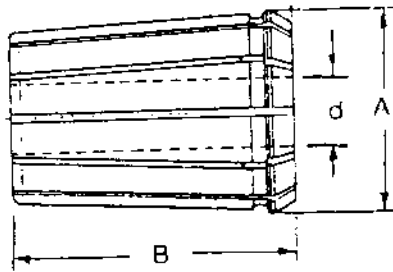

Type	A mm	Size Range	d mm	In steps of	Clamping Range mm	B mm
RDO 25	25.5	2--16		0.5	1.5--16	40
RDO 35	35.05	2--25		0.5	1.5--25	52
RDO 44	43.7	2--32		0.5	3.5--32	60

RUN OUT OF COLLETS

TOTAL INDICATOR READING (TIR)

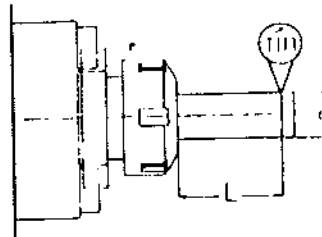

l mm	d mm	DIN 6388		d mm	DIN6341	
		Normal Precision mm	High Precision mm		Normal Precision mm	High Precision mm
16	3.0-5.9	0.015	0.008	3.0-5.9	0.020	0.010
25	6.0-9.9	0.015	0.008	6.0-9.9	0.020	0.010
40	10.0-17.9	0.020	0.010	10.0-17.9	0.030	0.020
50	18.0-23.9	0.020	0.010	18.0-26.9	0.040	0.020
60	24.0-29.9	0.020	0.010	27.0-34.0	0.040	0.020
80	30.0-50	0.030	0.015	---	---	---

ELMECA MACHINE TOOL ACCESSORIES

COLLECT CHUCKS FOR RD COLLECTS

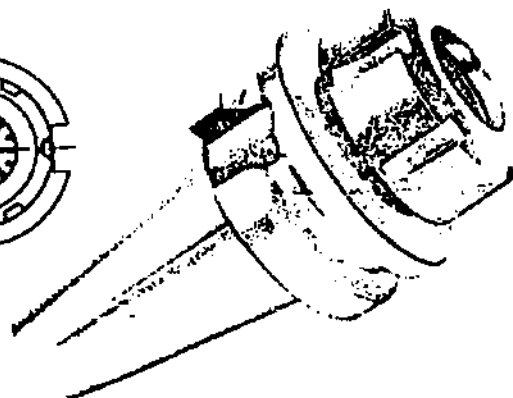
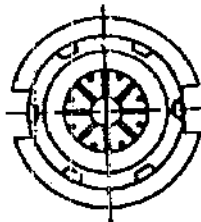
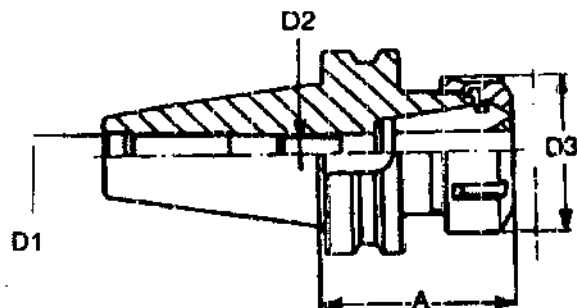

BT
MAS403
Japanese
Standard

TYPE	COLLET	SPANNER	NUT	A mm	D ₁ M	D ₂ M	D ₃ mm
BT30 x A120 / RD 16M	RD16	E16M	UM/RD 16M	120	12	8	22
BT 35 x A 70/RD 16	RD16	GS25	UM/RD16	70	12	8	28
BT 35 x A 60/RD 25	RD25	E-25	UMRD25+KM/RD25	60	12	18x1.2	42
BT 35 x A70/RD 32	RD 32	E-32	UM/RD32+KM/RD32	70	12	22x1.5	50
BT35 x A100/RD 32	RD 32	E-32	UM/RD32+KMRD32	100	12	22x1.5	50
BT35 x A 120/RD 16M	RD 16	E 16M	UM/RD16M	120	12	8	22
BT35 x A135/RD 20M	RD20	E20M	UM/RD20M	135	12	10	28
BT40 x A 70XRD 16	RD 16	GS25	UM/RD 16	70	16	8	28
BT40 x A 70/RD 20	RD 20	GS30	UM/RD20	70	16	10	34
BT40 x A 125/RD16M	RD 16	E16M	UM/RD16M	125	16	8	22
BT40 x A 135 /RD20M	RD 20	E20M	UM/RD20M	135	16	10	28
BT40 x A 150/RD 25M	RD 25	E20M	UM/RD25M	150	16	18x1.2	35
BT40 x A 70/RD32	RD 32	E-32	UM/RD32 + KM/RD32	70	16	18x1.2	50
BT40 x A 80/RD40	RD 40	E-40	UM/RD40 + KM/RD40	80	16	18x1.2	63
BT45 x A125/RD16M	RD 16	E-16M	UM/RD16M	125	20	8	22
BT45 x A 80/RD40	RD 40	E-40	UM/RD40+KM/RD40	80	20	18x1.2	63
BT45 x A 80/RD50	RD 50	E-50	UM/RD50+KM/RD50	80	20	22x1.5	78
BT50 x A 135/RD16M	RD 16	E-16M	UM/RD16M	135	24	8	22
BT50 x A 80/RD40	RD 40	E-40	UM/RD40+KM/RD40	80	24	22x1.5	63
BT50 x a 80/RD50	RD 50	E-50	UM/RD50+KM/RD50	80	24	22x1.5	78